

4x 1/4" NPT threaded holes

Center hole: 5/16" UNC-18
 min. thread engagement: 0.350"
 max. hole depth 0.500"

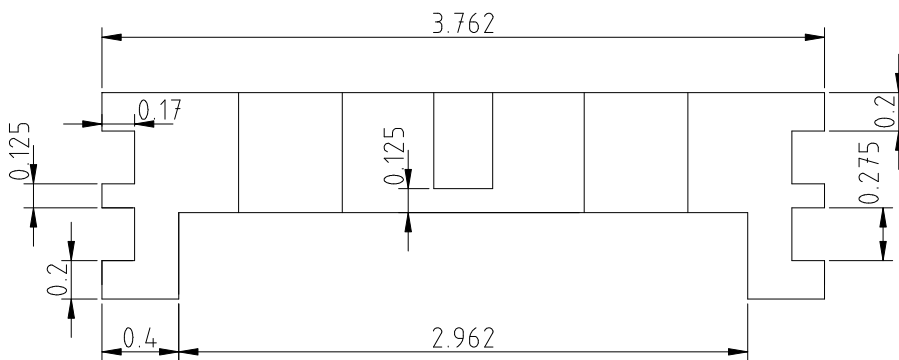

Chamfer bottom left and right corners (as shown on side view) to 45-degree angle 0.0625" from the edge

DO NOT chamfer top left and right corners (as shown on side view).

O-rings: Viton Shore A 75-340 (nominal OD 3-3/4", thickness 3/16")